

9554 Inniswylde Dr
Baton Rouge, LA 70809

 **LOGO** COMING
SOON

Powered by homes.theadvocate.com

MLS# 2025005193

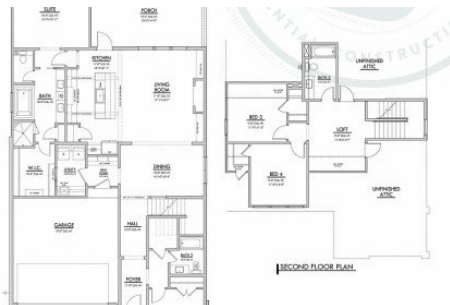

\$629,900

4 Bedrooms | 3 Bathrooms | 2,493 Sqft

The Glasgow floor plan offers great functionality and style. This two story homes a guest suite and primary suite downstairs, a large loft area upstairs along with 2 bedrooms and a full bath. Navigate through the front foyer and formal dining area to the true heart of the home featuring the kitchen and main living area. From reclaimed beams, brick columns, a cozy fireplace, and a great view of the backyard, it has it all. When you are ready to wind down, you can retreat to the primary suite privately located at the back of the home. It offers a spa like bath with a freestanding tub and full glass walk in shower. Don't wait to find out all of the amazing features of this home with tons of style, luxury, and function. A few of the selected upgrades include: reclaimed beams in kitchen/living, brick columns, cast iron sink in kitchen, upgraded kitchen hood, marble flooring in primary bath and guest bath, guest baths with tile surround, and many more!



Heather Kirkpatrick
Phone: (225) 252-0668

Keller Williams Realty Premier Partners

For full listing details, please scan:

