

29297 Highway 11
Port Sulphur, LA 70083



LOGO COMING
SOON

Powered by homes.theadvocate.com

MLS# 2026004130

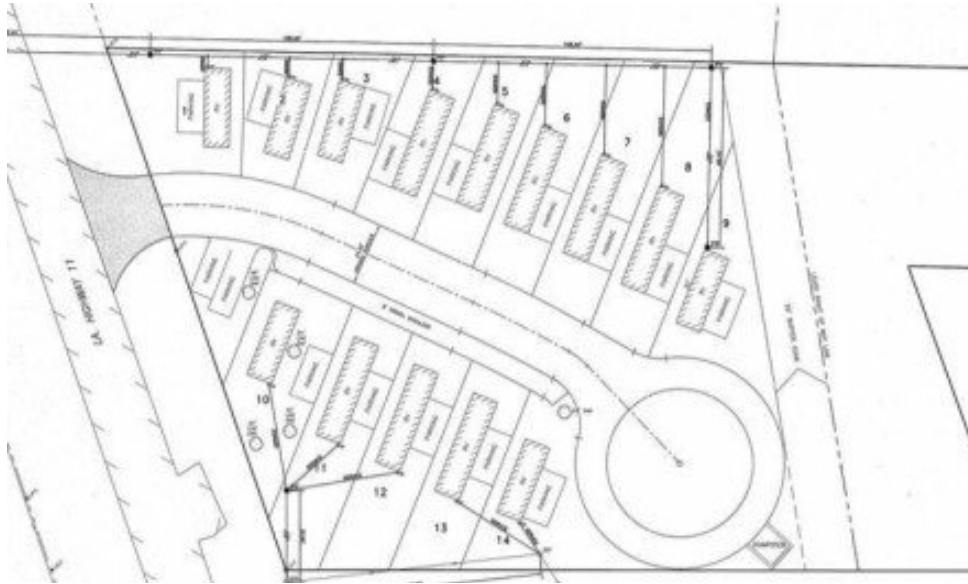

\$550,000

Looking for your next profitable venture? This RV campground offers the perfect blend of scenic surroundings, and long-term growth potential. Located approximately 6 minutes from grocery store and 15 minutes from the LNG plant. Whether you re an investor, a retiree seeking a lifestyle business, or someone dreaming of owning a campground, this property checks all the boxes! Turnkey and ready for new ownership



Allison Parker
Phone: (225) 614-3250
Crystal Bonin Realty

For full listing details, please scan:

